

Case IH

Engine No.	Cylinder			Piston			Piston Type
	Cyl.	Bore mm	Length mm	Pin Ø mm	Length mm	No. of Rings	
DT268	4	100	216.1	38	106.9	3	With combustion chamber
Applications: 4240							

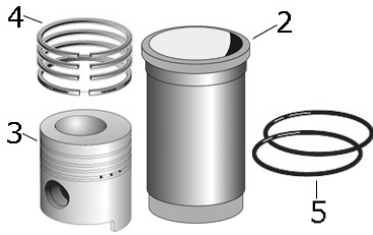

Description	Notes	OEM Ref:	
1	Piston and Liner Set	-	S.37846
2	Liner	3144682R3	S.57620
3	Piston	194475A1	S.37826
4	Piston Ring Set	3144977R91	S.57637
5	Liner Seal	3228344R1	S.57622
6	Head Gasket Set	1967014C1	S.57678
7	Bottom Gasket Set	1967011C1	S.57690
8	Rocker Cover Gasket	3138642R1	S.57686
9	Head Gasket	3228362R2	S.57682
10	Sump Gasket	3144697R2	S.57697

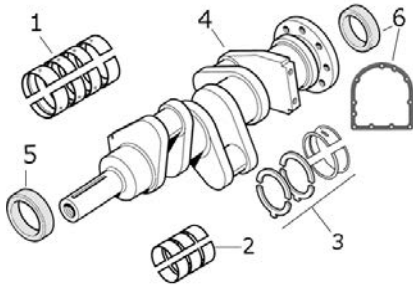
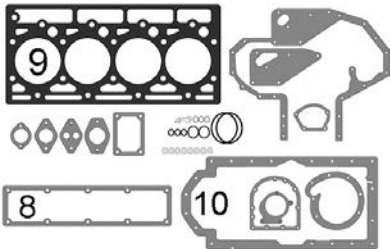

	Main Bearings Set (Std.)		3055129R21 x1 3055130R21 x4	S.57655
1	Main Bearings Set +0.010"		3056820R11 x1 3056832R21 x4	S.57660
+				
3	Main Bearings Set +0.020"		3056875R11 x1 3056877R21 x4	S.57661
	Main Bearings Set +0.030"		3055776R11 x1 3055779R21 x4	S.57662
2				
4	Oil Seal	80 x 100 x 13mm	3228401R91	S.57822
5	Seal Kit	Front crankshaft seals. Contains: O'Ring, distance ring, oil seal, dowel pins	3228133R93 713778R1 x1 3228401R91 x1 932681R1 x1 932652R1 x1 932224R1 x1	S.57672
6	Oil Seal	110 x 130 x 12.7mm	3138701R91	S.57670
	Rear Main Housing Gasket		3055215R2	S.57692

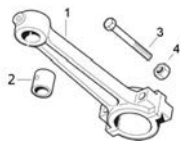

1				
2				
3				
4				

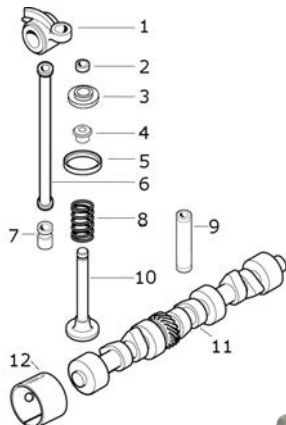

1				
2				
3				
4	Valve Stem Seal Kit	Pack of 8pcs	3228677R91	S.57876
5				
6				
7	Valve Tappet	Camshaft follower	3055052R1	S.57372
8	Valve Spring		3055060R1	S.57606
9	Valve Guide		129322A1	S.57610
10	Inlet Valve		3055055R2	S.57602
	Exhaust Valve		3055056R2	S.57604
11				
12				



13	Engine Oil Pump		3136430R95	S.57831
----	-----------------	--	------------	----------------