

Case IH

Engine No.	Cylinder			Piston			Piston Type
	Cyl.	Bore mm	Length mm	Pin Ø mm	Length mm	No. of Rings	
D310	6	98.43	201.1	36	102/107	3	With combustion chamber
Applications: 946, 955							

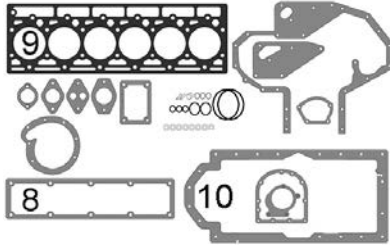

Description	Notes	OEM Ref:	
1 Piston, Ring & Liner Kit		3218758R95	S.57847
2 Liner		3139587R3	S.57616
3 Piston		-	S.57625
4 Piston Ring Set		3218416R92	S.57632
4 Piston Ring Set		-	S.37861
5 Liner Seal		3228344R1	S.57622
1 Piston, Ring & Liner Kit		3139586R95	S.57850
2 Liner		3139587R3	S.57616
3 Piston (Al-Fin Ring)		3139586R95	S.57624
4 Piston Ring Set		3139594R91	S.57633
5 Liner Seal		3228344R1	S.57622
6 Head Gasket Set		3136801R99	S.57679
7 Bottom Gasket Set		1967013C1	S.57691
8 Rocker Cover Gasket		3138688R1	S.57687
9 Head Gasket		3228019R2	S.57683
10 Sump Gasket		3055987R2	S.57698

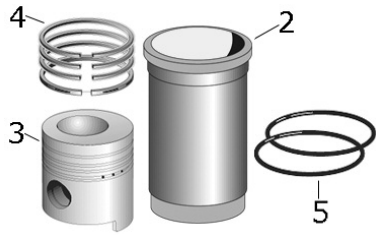
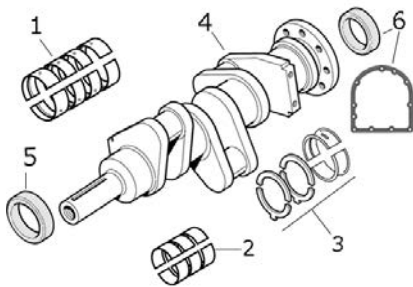

	Main Bearings Set (Std.)		3055129R21 x1 3055130R21 x6	S.57656
1	Main Bearings Set +0.010"		3056820R11 x1 3056832R21 x6	S.57663
3	Main Bearings Set +0.020"		3056875R11 x1 3056877R21 x6	S.57664
	Main Bearings Set +0.030"		3055776R11 x1 3055779R21 x6	S.57665
	Conrod Bearings Set (Std.)		3055351R91 x6	S.57640
2	Conrod Bearings Set +0.010"		3056834R11 x6	S.57647
	Conrod Bearings Set +0.020"		3056879R11 x6	S.57648
	Conrod Bearings Set +0.030"		3055781R11 x6	S.57649

4	Oil Seal	80 x 100 x 13mm	3228401R91	S.57822
5	Seal Kit	Front crankshaft seals. Contains: O'Ring, distance ring, oil seal, dowel pins	3228133R93 713778R1 x1 3228401R91 x1 932681R1 x1 932652R1 x1 932224R1 x1	S.57672
6	Oil Seal	110 x 130 x 12.7mm	3138701R91	S.57670
	Rear Main Housing Gasket		3055215R2	S.57692

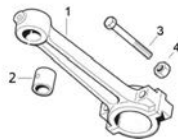

1				
2	Small End Bush	Unfinished	3132018R2	S.57674
3				
4				

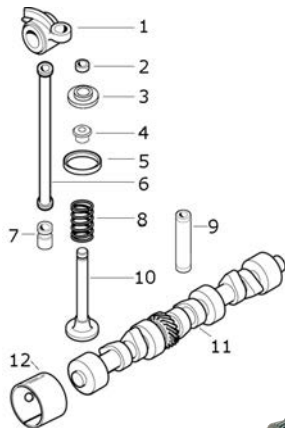

1				
2				
3				
4	Valve Stem Seal Kit	Pack of 6pcs	3218399R91	S.57615
5				
6				
7	Valve Tappet	Camshaft follower	3055052R1	S.57372
8	Valve Spring		3055060R1	S.57606
9	Valve Guide		129322A1	S.57610
10	Inlet Valve		3055055R2	S.57602
	Exhaust Valve		3055056R2	S.57604
11				
12				

13	Engine Oil Pump		3136433R95	S.57716
----	-----------------	--	------------	----------------