

Case IH	Engine No.	Cylinder			Piston			
		Cyl.	Bore mm	Length mm	Pin Ø mm	Length mm	No. of Rings	Piston Type
	DT358	6	98.43	216.1	38	107	3	With combustion chamber

Applications: 1246, 1255

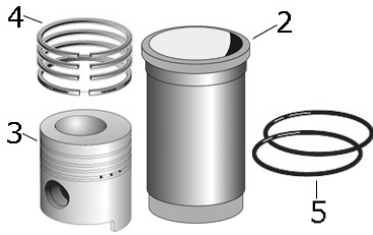

Description	Notes	OEM Ref:	
1	Piston, Ring and Liner Kit	3144516R97	S.37844
2	Liner	3139592R4	S.57617
3	Piston and Ring Set	-	S.37824
4	Piston Ring Set	3218416R92	S.57632
5	Piston Ring Set	-	S.37861
5	Liner Seal	3228344R1	S.57622

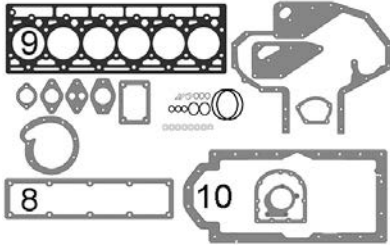

6	Head Gasket Set	3138751R96	S.38979
7	Bottom Gasket Set	1967013C1	S.57691
8	Rocker Cover Gasket	3138688R1	S.57687
9	Head Gasket	3228019R2	S.57683
10	Sump Gasket	3055987R2	S.57698

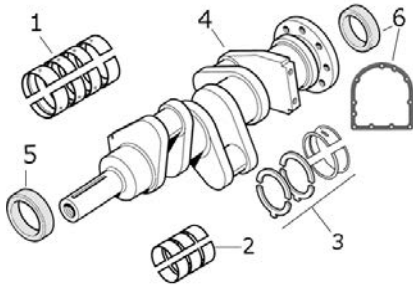

	Main Bearings Set (Std.)	3055129R21 x1 3055130R21 x6	S.57656
1	Main Bearings Set +0.010"	3056820R11 x1 3056832R21 x6	S.57663
3	Main Bearings Set +0.020"	3056875R11 x1 3056877R21 x6	S.57664
	Main Bearings Set +0.030"	3055776R11 x1 3055779R21 x6	S.57665
	Conrod Bearings Set (Std.)	-	S.37895
2			
4	Crankshaft	3136036R95	S.56930
	Oil Seal	80 x 100 x 13mm	3228401R91 S.57822
5	Seal Kit	Front crankshaft seals. Contains: O'Ring, distance ring, oil seal, dowel pins	3228133R93 713778R1 x1 3228401R91 x1 932681R1 x1 932652R1 x1 932224R1 x1 S.57672
6	Oil Seal	110 x 130 x 12.7mm	3138701R91 S.57670
	Rear Main Housing Gasket	3055215R2	S.57692

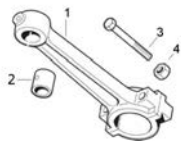

1			
2			
3			
4			

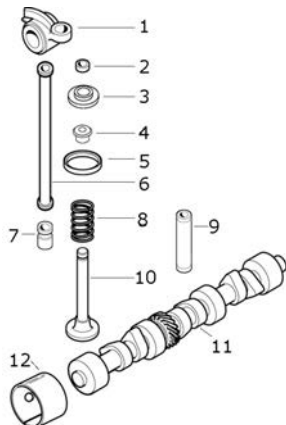

1			
2			
3			
4	Valve Stem Seal Kit	Pack of 6pcs	3218399R91 S.57615
5			
6			
7	Valve Tappet	Camshaft follower	3055052R1 S.57372
8	Valve Spring		3055060R1 S.57606
9	Valve Guide		129322A1 S.57610
10	Inlet Valve		3055055R2 S.57602
	Exhaust Valve		3055056R2 S.57604
11			
12			

13