

Case IH

Engine No.	Cylinder			Piston			Piston Type
	Cyl.	Bore mm	Length mm	Pin Ø mm	Length mm	No. of Rings	
DT402	6	100	216.1	38	107	3	With combustion chamber
Applications: 1455							

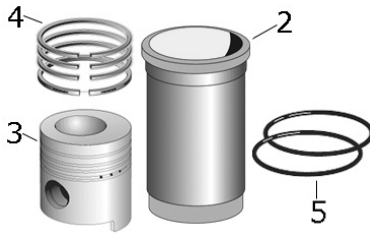

	Description	Notes	OEM Ref:	
1	Conjunto camisa ,pistão, e segmentos		3218915R95	S.37845
2	Liner		3144682R3	S.57620
3	Piston and Ring Set		-	S.37825
4	Piston Ring Set		3218920R91	S.37827
5	Liner Seal		3228344R1	S.57622

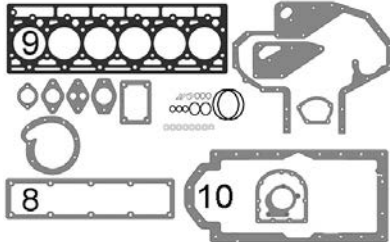

6	Head Gasket Set		3138751R96	S.38979
7	Bottom Gasket Set		1967013C1	S.57691
8	Rocker Cover Gasket		3138688R1	S.57687
9	Head Gasket		3228019R2	S.57683
10	Sump Gasket		3055987R2	S.57698

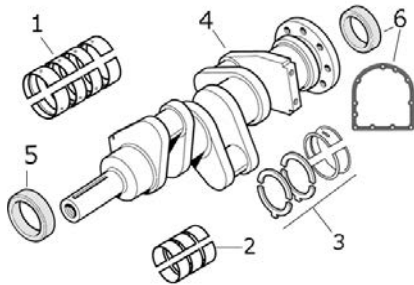

	Main Bearings Set (Std.)		3055129R21 x1 3055130R21 x6	S.57656
1	Main Bearings Set +0.010"		3056820R11 x1 3056832R21 x6	S.57663
3	Main Bearings Set +0.020"		3056875R11 x1 3056877R21 x6	S.57664
	Main Bearings Set +0.030"		3055776R11 x1 3055779R21 x6	S.57665
2				
4	Oil Seal	80 x 100 x 13mm	3228401R91	S.57822
5	Seal Kit	Front crankshaft seals. Contains: O'Ring, distance ring, oil seal, dowel pins	3228133R93 713778R1 x1 3228401R91 x1 932681R1 x1 932652R1 x1 932224R1 x1	S.57672
6	Oil Seal	110 x 130 x 12.7mm	3138701R91	S.57670
	Rear Main Housing Gasket		3055215R2	S.57692

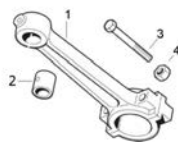

1				
2				
3				
4				

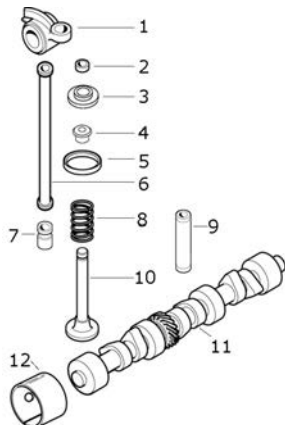

1				
2				
3				
4	Valve Stem Seal Kit	Pack of 6pcs	3218399R91	S.57615
5				
6				
7	Valve Tappet	Camshaft follower	3055052R1	S.57372
8	Valve Spring		3055060R1	S.57606
9	Valve Guide		129322A1	S.57610
10	Inlet Valve		3055055R2	S.57602
11				
12				

13