

Case IH	Engine No.	Cylinder			Piston			
		Cyl.	Bore mm	Length mm	Pin Ø mm	Length mm	No. of Rings	Piston Type
	D66	2	82.55	179.5	28	99	5	-

Applications: D212, D214, D215

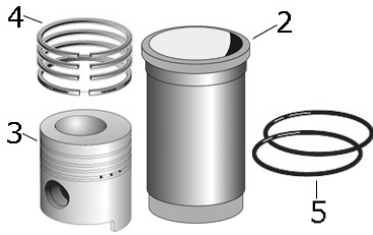

	Description	Notes	OEM Ref:
1	Piston and Liner Set		3054295R91 <b>S.37840</b>
2	Liner		- <b>S.37829</b>
3			
4	Piston Ring Set		- <b>S.37843</b>
5			

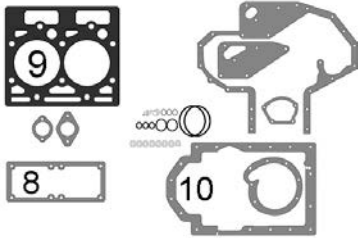

6	Top Gasket Set		3051138R92 <b>S.38976</b>
7			
8			
9			
10			

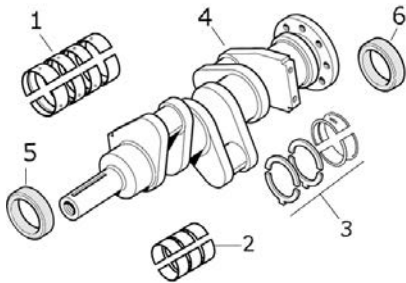

1			
2			
3			
4			
5			
6			
1	Conrod Bearings Pair		710327R1 <b>S.37848</b>

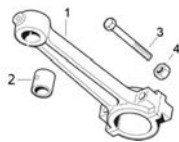

1			
2			
3			
4			

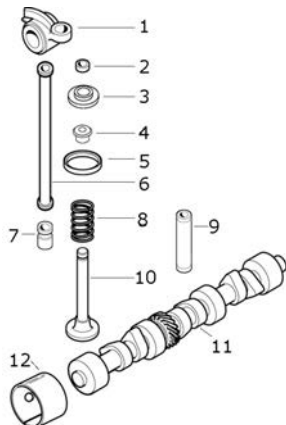

1			
2			
3			
4			
5			
6			
7			
8			
9	Valve Guide		713799R1 <b>S.37940</b>
10	Inlet Valve		713384R2 <b>S.37933</b>
11	Exhaust Valve		713385R2 <b>S.37937</b>
12			

13