

Case IH	Engine No.	Cylinder			Piston			
		Cyl.	Bore mm	Length mm	Pin Ø mm	Length mm	No. of Rings	Piston Type
	D74	2	87.31	179.4	28	99	5	-

Applications: D217, D219

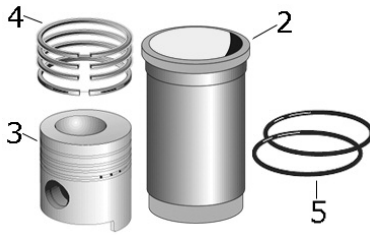

	Description	Notes	OEM Ref:
1	Piston and Liner Set		714852R98 S.37842
2	Liner		- S.37810
3	Piston and Ring Set		- S.37822
4	Piston Ring Set		- S.37830
5	Liner Seal		- S.38998

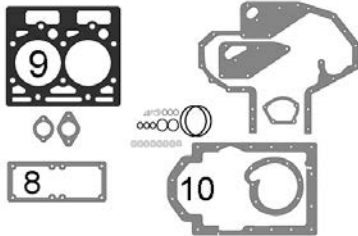

6	Top Gasket Set		3051140R92 S.38974
7			
8			
9			
10			

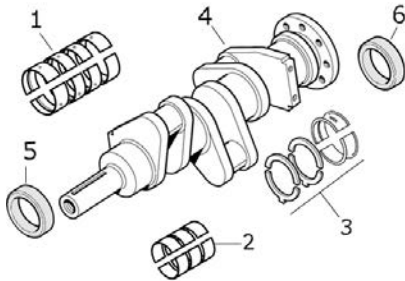

1			
2			
3			
4			
5			
6			
	Conrod Bearings Pair		710327R1 S.37848

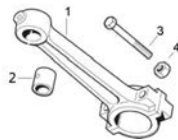

1			
2			
3			
4			

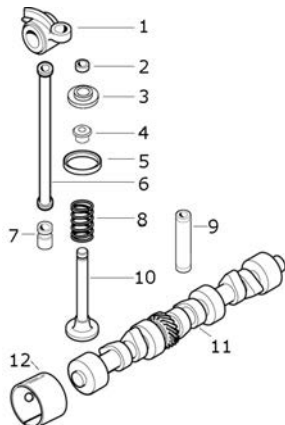

1			
2			
3			
4			
5			
6			
7			
8			
9	Valve Guide		713799R1 S.37940
10	Inlet Valve		713384R2 S.37933
	Exhaust Valve		713385R2 S.37937
11			
12			

13			
----	--	--	--