

David Brown

Engine No.	Cylinder			Piston			No. of Rings	Piston Type
	Cyl.	Bore mm	Length mm	Pin Ø mm	Length mm			
AD4.55	4	99.47	212.72	31.72	105.68	4	-	
Applications: 995, 996, 1290 <11052360, 1390, 1200, 1210, 1212, 1294								

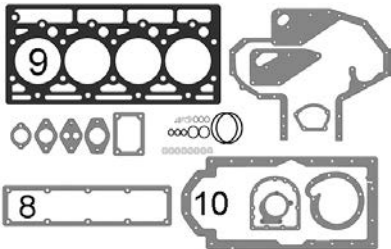

Description	Notes	OEM Ref:
1		
2 Liner		K964857 S.57504
3 Piston		K949474 S.57506
4 Piston Ring Set		K261069 S.57508



6	Head Gasket Set	K262752 K262767	S.57551
7	Bottom Gasket Set	K262765	S.57561
8	Rocker Cover Gasket	K905229	S.57557
9	Head Gasket	K262750	S.57554
10	Sump Gasket	K918684	S.57567

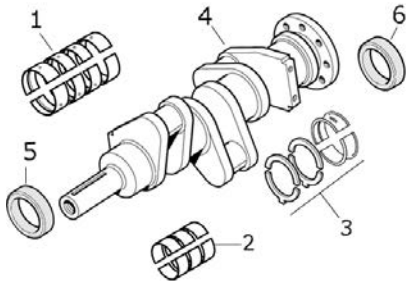

1	Main Bearings Set (Std.)	K928541 (x6)	S.57527
	Main Bearings Set +0.010"	K928554 (x6)	S.57530
2	Conrod Bearings Set (Std.)	K207436 (x8)	S.57520
	Conrod Bearings Set +0.010"	K207497 (x8)	S.57521
	Thrust Bearings Set	K928542 K928543	S.57537
3	Thrust Bearings Set +0.005"	K928560 K928561	S.57538
4	Crankshaft	K210100	S.57959
5	Oil Seal	2 1/8" x 2 7/8" x 3/8"	K628127 S.57541
6	Rope Seal Set 2pcs	K262783	S.57543

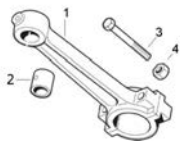

1			
2	Small End Bush	K31669	S.57548
3			
4			

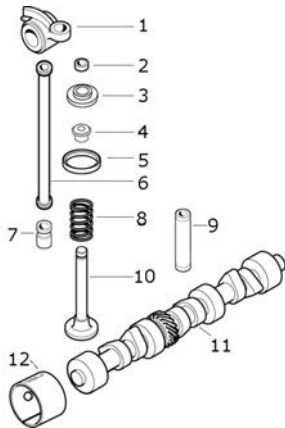

1			
2	Valve Collet	K943439	S.41413
3			
4			
5			
6			
7			
8	Valve Spring Inner	K921435	S.57502
	Valve Spring Outer	K921436	S.57503
9			
10	Engine Valve	Inlet / Exhaust	K928622 S.57500
	Engine Valve	Inlet / Exhaust	K928622 S.57500
11			
12			

13			
----	--	--	--