

**Fiat**

Engine No.	Cylinder			Piston			Type
	Cyl.	Bore mm	Length mm	Pin Ø mm	Length mm	No. of Rings	
<b>8045.05</b>	4	104.00	198.00	38	108.5	3	-
Applications: 80-66, 80-66F, 80-76F, 80-90, 82-93, 82-94, L75							

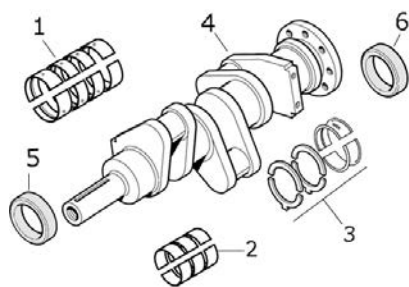

Description	Notes	OEM Ref:	
1		4770623	<b>S.62035</b>
2 Liner		1930186	<b>S.62023</b>
3 Piston and Ring Set		1930191	<b>S.62029</b>
4 Piston Ring Set			
6 Head Gasket Set		1930249	<b>S.62106</b>
7 Complete Gasket Set		1930248	<b>S.62105</b>
8 Rocker Cover Gasket	(Flat Type)	4782836	<b>S.62126</b>
9			
10 Sump Gasket		1940004	<b>S.62114</b>



	Main Bearings Pair (Std.)		1930176	<b>S.62049</b>
1	Main Bearings Pair +0.010"		1930177	<b>S.62345</b>
	Main Bearings Pair +0.020"		1930178	<b>S.62454</b>
	Conrod Bearings Pair (Std.)		1930181	<b>S.62043</b>
2	Conrod Bearings Pair +0.25mm		1930182	<b>S.62044</b>
	Conrod Bearings Pair +0.50mm		1930183	<b>S.62451</b>
	Thrust Bearings Set		1901385	<b>S.62053</b>
3	Thrust Bearings Set +0.25mm		1901386	<b>S.58945</b>
4	Crankshaft		4785110	<b>S.59052</b>
5	Oil Seal	65 x 42 x 10mm	98461684 40101331	<b>S.62068</b>
6	Oil Seal	135 x 114 x 12mm	98461686 40101341	<b>S.62073</b>



1	Conrod	Ø38mm Pin	4780624 98461751	<b>S.58941</b>
2	Small End Bush	38mm Piston pin	4766404	<b>S.62038</b>
3				
4				

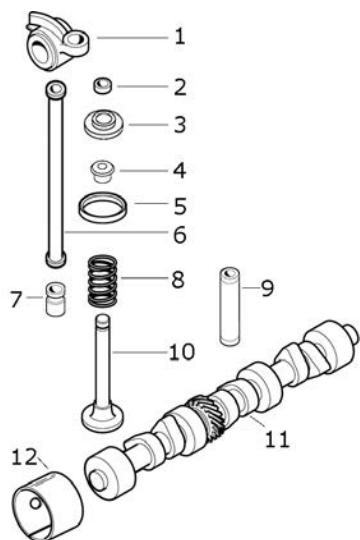

1				
2	Valve Collet		14196670	<b>S.59051</b>
3				
4				
5				
6				
7				
8	Valve Spring		4780108	<b>S.62066</b>
9	Valve Guide	Inlet & exhaust	4802126	<b>S.62062</b>
10	Inlet Valve		4824417	<b>S.62057</b>
	Exhaust Valve		4784889	<b>S.62060</b>
11				
12	Camshaft Bush Set	3 Bushes	4603449 + 4603450 + 4603451	<b>S.62121</b>



13	Engine Oil Pump		4705827	<b>S.62133</b>
----	-----------------	--	---------	----------------