

Ford	Engine No.	Cylinder			Piston		
		Cyl.	Bore mm	Length mm	Pin Ø mm	Length mm	No. of Rings
	442 4.2 Ltr.	4	111.76	208.15	38.1	110.89	4
Applications: 4830, 5000, 5030, 5100, 5110, 5600, 5610, 5900, 6600, 6700 (see also 438 and 444 engines)							

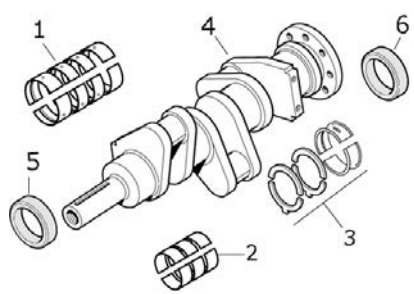

Description	Notes	OEM Ref:
Ford (5000 04/1968>), (5600 10/1980>), 5610, (5900 >07/1987)		
1	Piston, Ring & Liner Kit	- S.65891
2	Liner	83912946 D7NN6055A S.65827
3	Piston (Al-Fin Ring)	83937063 D4NN6108AA S.65820
4	Piston Ring Set	83917468 DJPN6149W S.65997
Ford 4830, 5030		
1		
2	Liner	83912946 D7NN6055A S.65827
3		
4	Piston Ring Set	83917468 DJPN6149W S.65997
6	Head Gasket Set	0.067" Thickness 83977023, 87800517, CFPN6008C S.65297
7	Bottom Gasket Set	81813951 CFPN6A008C S.65300
8	Rocker Cover Gasket	81817049 C7NN6584C S.65764
9	Head Gasket	Supercedes S.65304 83977023 F1NN6051BA S.65847
10	Sump Gasket	Supercedes S.66456 87802061 S.66368



	Main Bearings Set (Std.)	83927681 x 1 87790356 x 4 S.65223
1	Main Bearings Set +0.010"	83927683 x 1 81811585 x 4 S.65224
	Main Bearings Set +0.020"	83927684 x 1 81811586 x 4 S.65225
	Main Bearings Set +0.030"	83927685 x 1 81811587 x 4 S.65226
	Conrod Bearings Set (Std.)	Early Type Ø 36mm 83906780/1 DFPN6211A/B S.65199
2	Conrod Bearings Set +0.010"	83906783 DFPN6211D S.65200
	Conrod Bearings Set +0.020"	83906784 DFPN6211E S.65201
	Conrod Bearings Set +0.030"	83906785 DFPN6211F S.65202
Except Ford 4830 and 5030		
	Conrod Bearings Set (Std.)	Later Type Ø 32mm 87790322 FAPN6211G S.66072
2	Conrod Bearings Set +0.010"	87791051 FAPN6211J S.66073
	Conrod Bearings Set +0.020"	87790325 FAPN6211K S.66074
	Conrod Bearings Set +0.030"	87791053 FAPN6211E S.66075
4	Crankshaft	4.2" Stroke, Early Type, 78T, Ø36mm Big End Journals 81804029 C5NE6303K S.66141
Except Ford 5610, 5900		
5	Oil Seal	83 x 58 x 11.3mm 81815927 C5NN6700A S.65672
6	Oil Seal	141 x 120 x 11.3mm 83955247 E5NN6701BA S.65673

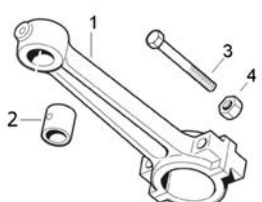

1	Conrod	Ø36mm Pin, Early Type C7NN6200A S.66043
2	Small End Bush	81803972 C5NE6207A S.65237
3	Conrod Bolt	83990584 C5NE6214A S.65979
4	Conrod Nut	83956276 358279S2 385279S2 S.65978