

Ford	Engine No.	Cylinder			Piston			
		Cyl.	Bore mm	Length mm	Pin Ø mm	Length mm	No. of Rings	
	444	4	111.76	208.53	38.1	127.12	4	Unhoned, Semi Finished Liner

Applications: 6410, 6600, 6700 (6600 and 6700 see also BDS442 engine)

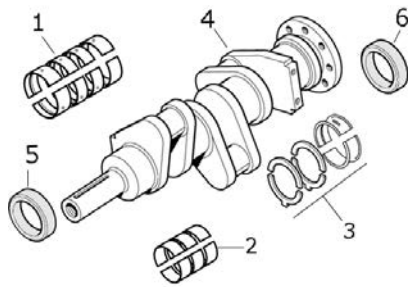

Description	Notes	OEM Ref:
Ford 6410, (6600 10/1980 - 12/1981), (6700 10/1980 - 12/1980)		
1	Piston, Ring & Liner Kit	-
		S.65890
2	Liner	83912946 D7NN6055A
		S.65827
3	Piston (Al-Fin Ring)	83928178 E0NN6108AA
		S.65821
4	Piston Ring Set	83917468 DJP6149W
		S.65997
6	Head Gasket Set	0.067" Thickness
		83977023, 87800517, CFPN6008C
		S.65297
7	Bottom Gasket Set	81813951 CFPN6A008C
		S.65300
8	Rocker Cover Gasket	81817049 C7NN6584C
		S.65764
Except Ford 6410>09/1989		
9	Head Gasket	Supercedes S.65304
		83977023 F1NN6051BA
		S.65847
10	Sump Gasket	Supercedes S.66456
		87802061
		S.66368



	Main Bearings Set (Std.)		83927681 x 1 87790356 x 4	S.65223
1	Main Bearings Set +0.010"		83927683 x 1 81811585 x 4	S.65224
	Main Bearings Set +0.020"		83927684 x 1 81811586 x 4	S.65225
	Main Bearings Set +0.030"		83927685 x 1 81811587 x 4	S.65226
2	Conrod Bearings Set (Std.)	Early Type Ø 36mm	83906780/1 DFPN6211A/B	S.65199
	Conrod Bearings Set +0.010"		83906783 DFPN6211D	S.65200
	Conrod Bearings Set +0.020"		83906784 DFPN6211E	S.65201
	Conrod Bearings Set +0.030"		83906785 DFPN6211F	S.65202
2	Conrod Bearings Set (Std.)	Later Type Ø 32mm	87790322 FAPN6211G	S.66072
	Conrod Bearings Set +0.010"		87791051 FAPN6211J	S.66073
	Conrod Bearings Set +0.020"		87790325 FAPN6211K	S.66074
	Conrod Bearings Set +0.030"		87791053 FAPN6211E	S.66075
4	Crankshaft	4.4" Stroke, Early Type, 78T, Ø36mm Big End Journals	83918890 D9NN6303AA	S.66042
5	Oil Seal	83 x 58 x 11.3mm	81815927 C5NN6700A	S.65672
6	Oil Seal	141 x 120 x 11.3mm	83955247 E5NN6701BA	S.65673

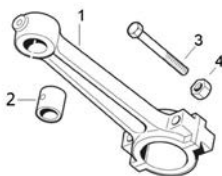

1	Conrod	Ø36mm Pin, Early Type	C7NN6200A	S.66043
2	Small End Bush		81803972 C5NE6207A	S.65237
3	Conrod Bolt		83990584 C5NE6214A	S.65979
4	Con Rod Nut		83956276 358279S2 385279S2	S.65978