

<b>Massey Ferguson</b>	Engine No.	Cylinder			Piston			
	<b>AT4.236</b>	Cyl.	Bore mm	Length mm	Pin Ø mm	Length mm	No. of Rings	Piston Type
		4	98.46	227.57	38.03	108.25	3	

Applications: 390T, 398, 560, 698T, 1007, 3065, 3070, 3075

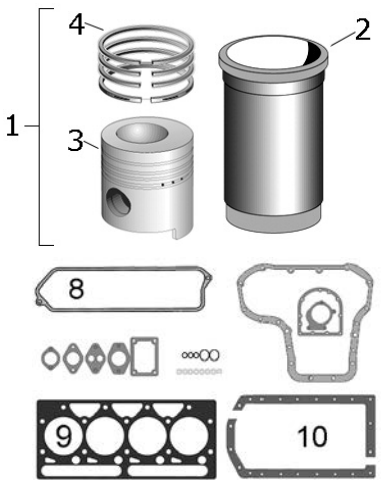

	Description	Notes	OEM Ref:	
1	Liner		744948M1, 31358394	<b>S.40434</b>
2	Liner		3637032M1, 3135X032	<b>S.41373</b>
3	Piston (Al-Fin Ring)		3637360M91, U5LP0022	<b>S.42198</b>
4	Piston Ring Set		747602M91, 41158145	<b>S.42208</b>
	Head Gasket Set		3637361M91, U5LT0046	<b>S.41955</b>
	Bottom Gasket Set	Supercedes S.48014 and Supercedes S.40611	747191M91, 3638515M91, U5LB0016, U5LN0016	<b>S.40610</b>
8	Rocker Cover Gasket		3638482M1, 3681A027	<b>S.42123</b>
9	Head Gasket	105mm Bore	746342M1, 3638845M1, 36812349, 3681E021	<b>S.40624</b>
	Head Gasket		3638294M1, 3637498M1, 3681E012, 3681E014	<b>S.41952</b>
10				

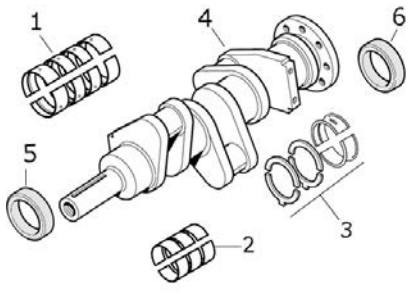

	Main Bearings Set (Std.)		735168M91, 81558, 423669	<b>S.40339</b>
1	Main Bearings Set +0.010"		735169M91, 81558A	<b>S.40340</b>
	Main Bearings Set +0.020"		735170M91, 81558B	<b>S.40341</b>
	Main Bearings Set +0.030"		735171M91, 81558C	<b>S.40342</b>
	Conrod Bearings Set (Std.)		736950M91, 85042, 423670	<b>S.40323</b>
2	Conrod Bearings Set +0.010"		736951M91, 85042A	<b>S.40324</b>
	Conrod Bearings Set +0.020"		736952M91, 85042B	<b>S.40325</b>
	Conrod Bearings Set +0.030"		736953M91, 85042C	<b>S.40326</b>
3	Thrust Bearings Set		747128M1, 747129M1, 31137551, 31137561, 424808	<b>S.40345</b>
	Thrust Bearings Set +0.075"		31137312, 31137322, 735742M1, 735743M1	<b>S.40346</b>
4				
	Flywheel Lock Tab		731192M1, 0921062	<b>S.40347</b>
	Ring Gear	115T	4222485M1+, 3637030M1, 32762145+, 33221328, 3408357M1, 731008M1, 410236	<b>S.40364</b>
5	Oil Seal - Front Timing Cover	2.375" x 3.125" x 0.375"	1446853M1	<b>S.40351</b>
6	Oil Seal	5.25" x 6.25" x 0.422" Viton. Alternative to S.41326	1447691M1, 2418F475, 70730050	<b>S.40356</b>