

**Fiat**

Engine No.	Cylinder			Piston			Type
	Cyl.	Bore mm	Length mm	Pin Ø mm	Length mm	No. of Rings	
<b>8035.05</b>	3	104.00	198.00	38	108.5	3	-
Applications: 60-66F, 60-90, 60-93, 60-94, L60, 60-76F							

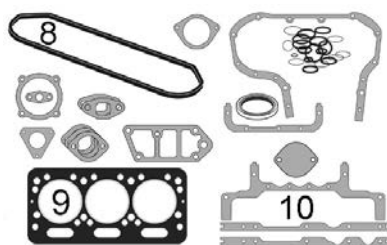

	Description	Notes	OEM Ref:	
1				
2	Liner		4770623	<b>S.62035</b>
3	Piston and Ring Set		1930186	<b>S.62023</b>
4	Piston Ring Set		1930191	<b>S.62029</b>



6	Head Gasket Set	Supercedes S.62084	1930258	<b>S.62102</b>
7	Complete Gasket Set	103mm Liner, Supercedes S.62101	1930257	<b>S.62083</b>
8	Rocker Cover Gasket		4783243	<b>S.62127</b>
9				
10	Sump Gasket		1940006	<b>S.62113</b>

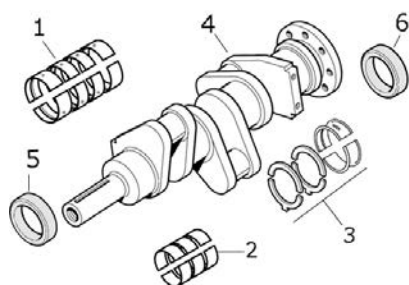

	Main Bearings Pair (Std.)		1930176	<b>S.62049</b>
1	Main Bearings Pair +0.010"		1930177	<b>S.62345</b>
	Main Bearings Pair +0.020"		1930178	<b>S.62454</b>
	Conrod Bearings Pair (Std.)		1930181	<b>S.62043</b>
2	Conrod Bearings Pair +0.25mm		1930182	<b>S.62044</b>
	Conrod Bearings Pair +0.50mm		1930183	<b>S.62451</b>
3	Thrust Bearings Set		1901385	<b>S.62053</b>
	Thrust Bearings Set +0.25mm		1901386	<b>S.58945</b>
4				
5	Oil Seal	65 x 42 x 10mm	98461684 40101331	<b>S.62068</b>
6	Oil Seal	135 x 114 x 12mm	98461686 40101341	<b>S.62073</b>

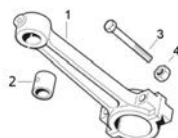

1	Conrod	Ø38mm Pin	4780624 98461751	<b>S.58941</b>
2	Small End Bush	38mm Piston pin	4766404	<b>S.62038</b>
3				
4				

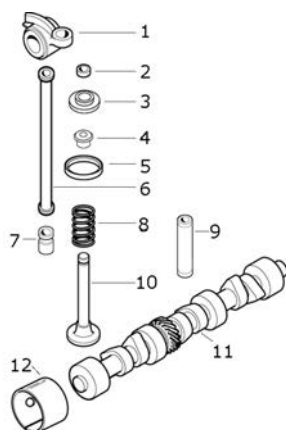

1				
2	Valve Collet		14196670	<b>S.59051</b>
3				
4				
5				
6				
7				
8	Valve Spring		4780108	<b>S.62066</b>
9	Valve Guide	Inlet & exhaust	4802126	<b>S.62062</b>
10	Inlet Valve		4824417	<b>S.62057</b>
	Exhaust Valve		4784889	<b>S.62060</b>
11	Camshaft	3 Cyl.	4824215 4784946	<b>S.59066</b>
12	Camshaft Bush Set	3 Bushes	4603449 + 4603450 + 4603451	<b>S.62121</b>



13	Engine Oil Pump		4705827	<b>S.62133</b>
----	-----------------	--	---------	----------------